

ENGINEER OF RECORD:
PLEASE VERIFY TORSIONAL
STABILITY OF BEAM.

CONTINUOUS STRUCTURAL
STEEL BY OTHERS

ELEV. VIEW

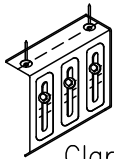

ClarkDietrich BUILDING SYSTEMS
FTC-500 WITH (3) PROPRIETARY
SCREWS AT TOP SCORE LINE TO
STUD AND ATTACHED TO STRL
STEEL AS REQ'D. BY DESIGN

ClarkDietrich BUILDING SYSTEMS
TYPICAL STUD

ENGINEER OF RECORD:
VERIFY GAP DEPTH.

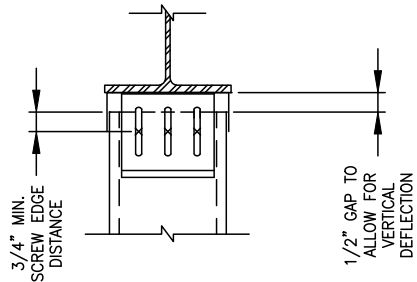

ELEV. VIEW

0" to 3/4" GAP = TOP SCORELINE
> 3/4" to 1-1/4" MAX. = MIDDLE SCORELINE
> 1-1/4" to 1-1/2" MAX. = BOTTOM SCORELINE

FAST TOP CLIPS (FTC5)-STEEL

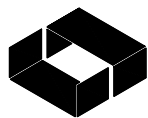

ClarkDietrich
BUILDING SYSTEMS

Engineering Services: (877) 832-3206

Technical Services: (888) 437-3244

The CAD detail library is intended to provide general framing details only and does not replace the judgments and designs of a qualified architect and/or engineer. The details are provided as a starting tool to assist the user in creating and detailing cold-formed steel framing construction details. Each detail including accompanying text must be thoroughly evaluated and approved by a qualified architect or engineer.

Find over 500 CAD details at cad.clarkdietrich.com

© Copyright 2019 ClarkDietrich