

RECOMMENDED CLIP SPACING

VERTICAL SPACING OF BM CLIPS TO FRAMING AT 10"–12" O.C.

FOR 16" O.C. STUD SPACING:
USAGE WILL BE 24 CLIPS PER 4X8 BARRIER MESH PANEL, 75 CLIPS PER 100 SF.

FOR 24" O.C. STUD SPACING:
USAGE WILL BE 16 CLIPS PER 4X8 BARRIER MESH PANEL, 50 CLIPS PER 100 SF.

(SPACING MAY BE INCREASED BASED ON THE CLIENTS NEEDS)

SECURE SIDE

ATTACK SIDE

NOTES:

REFER TO UL FILE NUMBER R19331 FOR FIRE RATED ASSEMBLIES WITH BARRIER MESH.

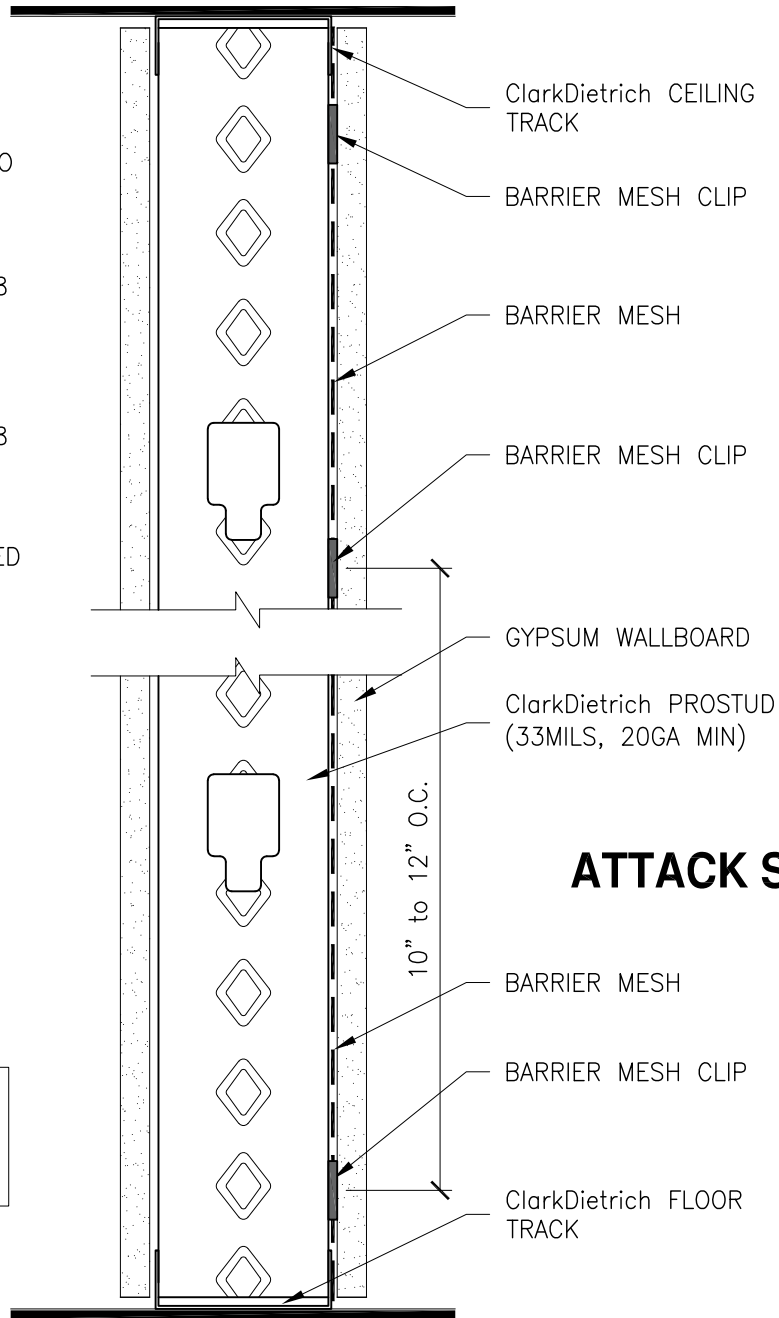

BARRIER MESH TYPICAL WALL SIDE



Engineering Services: (877) 832-3206

Technical Services: (888) 437-3244

The CAD detail library is intended to provide general framing details only and does not replace the judgments and designs of a qualified architect and/or engineer. The details are provided as a starting tool to assist the user in creating and detailing cold-formed steel framing construction details. Each detail including accompanying text must be thoroughly evaluated and approved by a qualified architect or engineer. | Find over 500 CAD details at cad.clarkdietrich.com | © Copyright 2025 ClarkDietrich