

# ClarkDietrich Shaftwall Construction Details

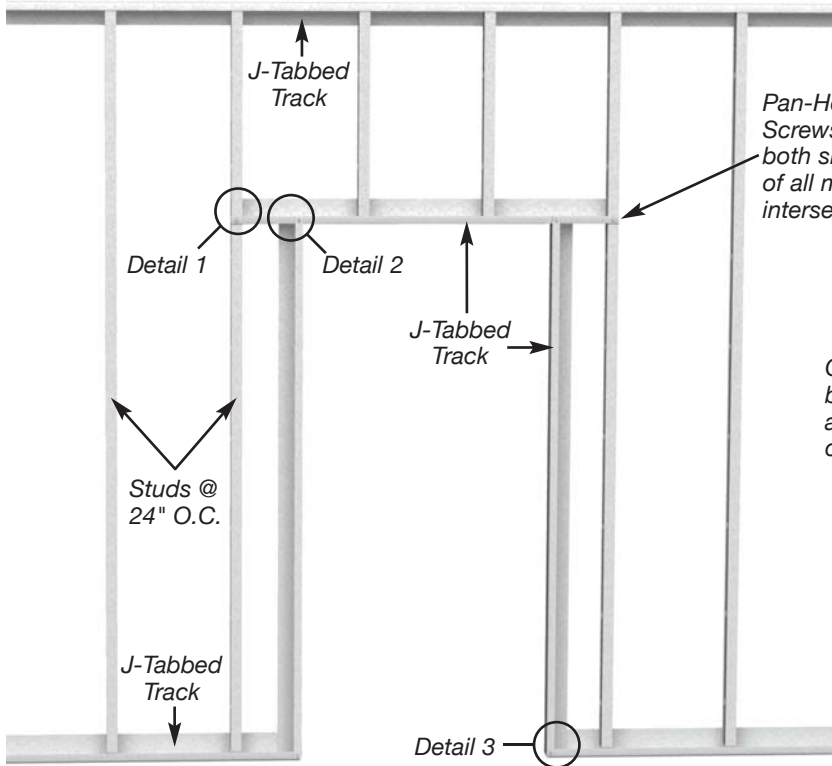

**Door Opening Room Side**

Pan-Head Screws on both sides of all metal intersections

J-Tabbed Track 20-gauge or heavier

Gypsum filler strips may be required where jambs are in place prior to wall construction

**Header Detail**

Tabs in J-Tabbed Track bent out @ 12" O.C.

Corner Bead

**Outside Corner**

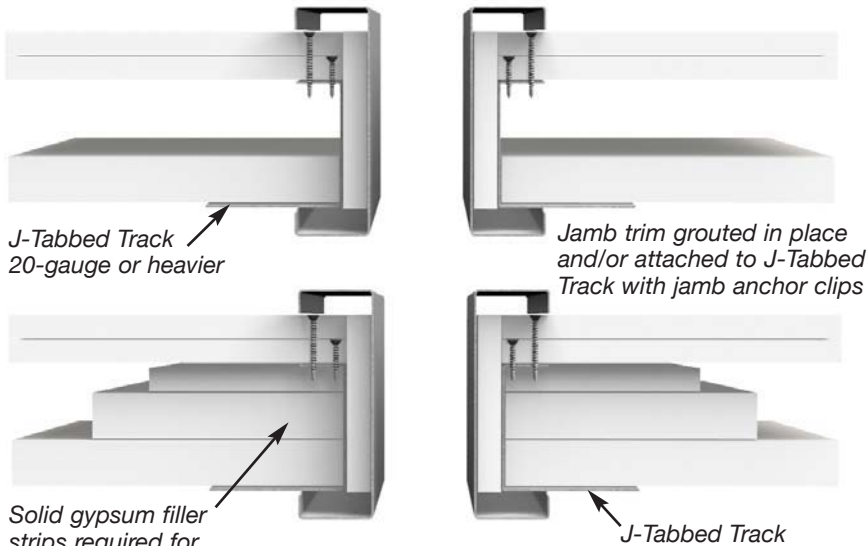

**Cross Section**

Attach to J-Tabbed Track prior to installation

Tabs in J-Tabbed Track bent out @ 12" O.C.

**Inside Corner**

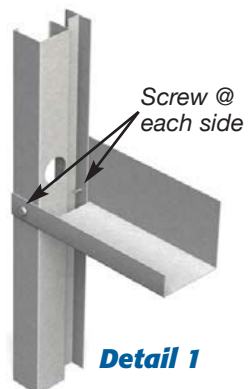

**Detail 1**

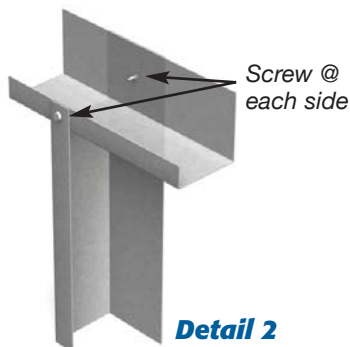

**Detail 2**

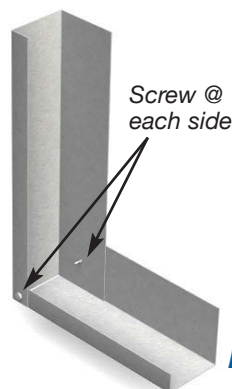

**Detail 3**

## Mechanical Penetrations

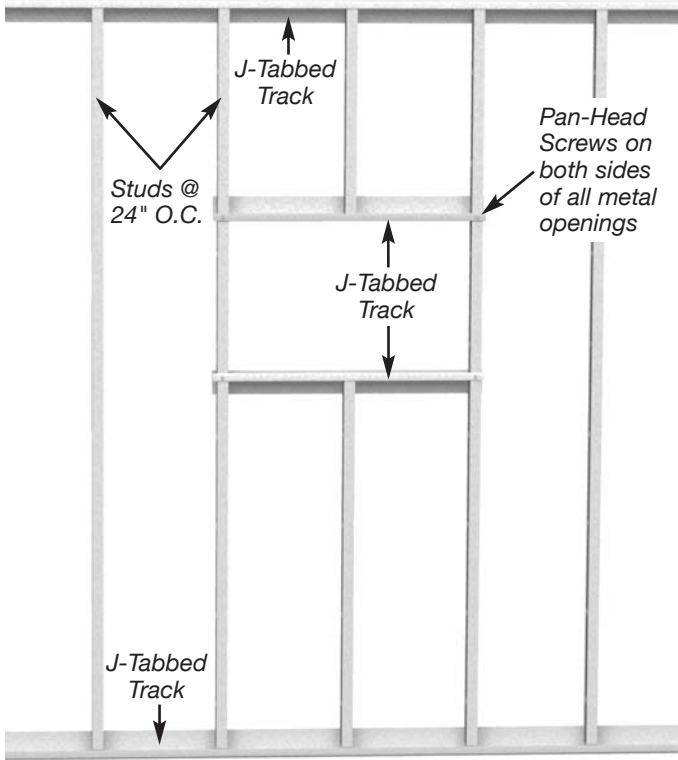

**Duct Opening Room Side**

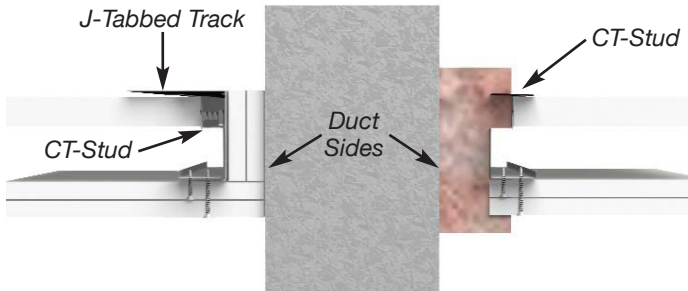

**Alternate Duct Detail**

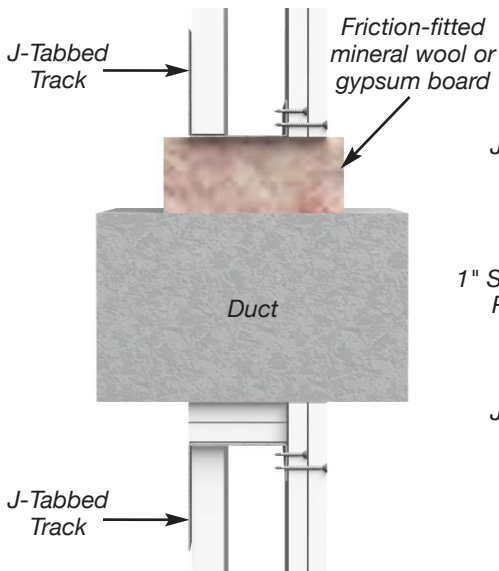

**Alternate Duct Detail**

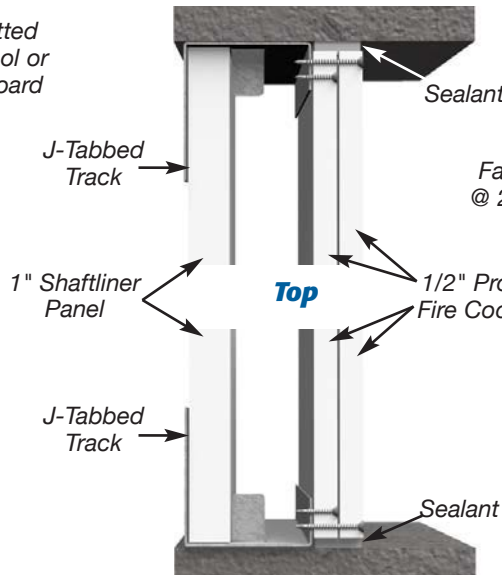

## Accessory Details

NOTE: Cavity depth requirements may vary according to services being installed

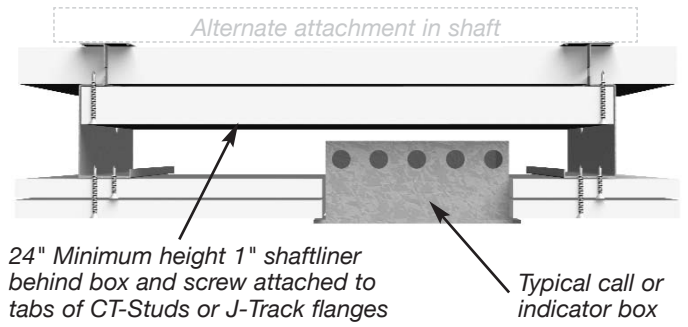

**Floor Indicator Box**

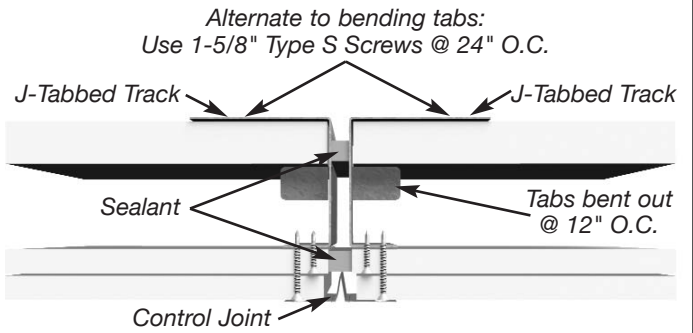

**Control Joint**



Install with 4" minimum oversize inside cavity or on shaft side

**Call Box-Outlet Box-Mail Chute**

