

## (BM-Clip) Barrier Mesh™ Clip Installation Recommendations

Barrier Mesh™ Clips (BM-Clips) are to be installed on the outside face of the wall framing which is to be protected. The ClarkDietrich BM-Clips act as “washers” for the attachment of the Barrier Mesh to framing members.

### Clip Information:

Clip Dimensions: 2.75” long, 1.50” wide  
Packaging: 300 Clips/carton, 4 lbs./carton  
Barrier Mesh: Size and gauge based on level of security required

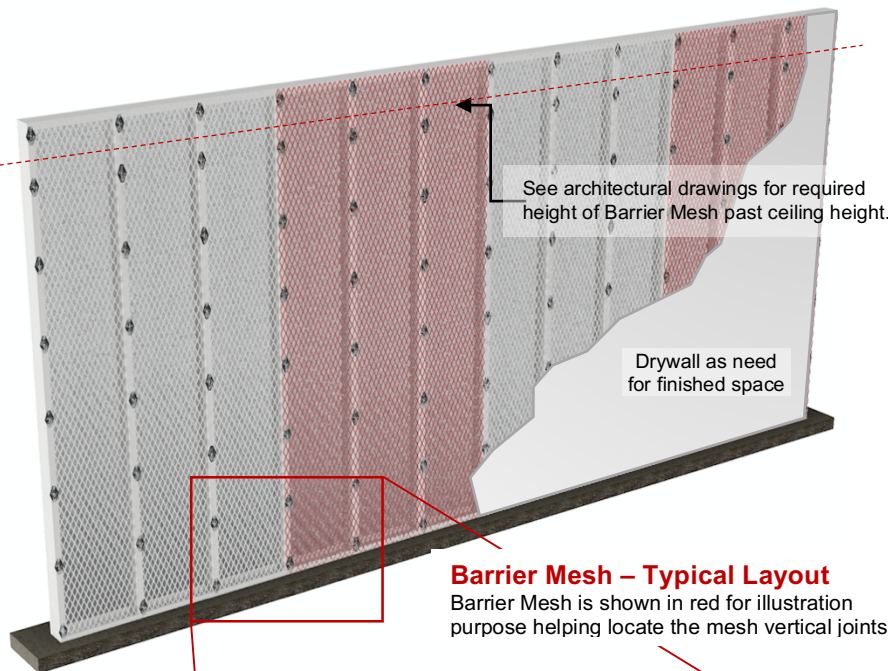

**Barrier Mesh – Typical Layout**  
Barrier Mesh is shown in red for illustration purpose helping locate the mesh vertical joints.

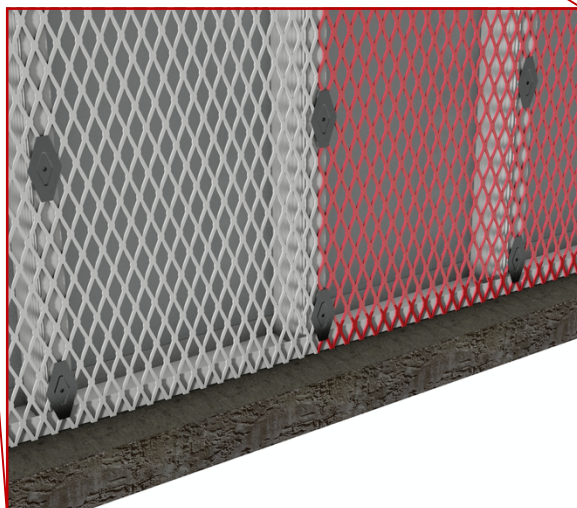

### Barrier Mesh Butt-Joint

See BM-Clip installation and spacing recommendations on the right.

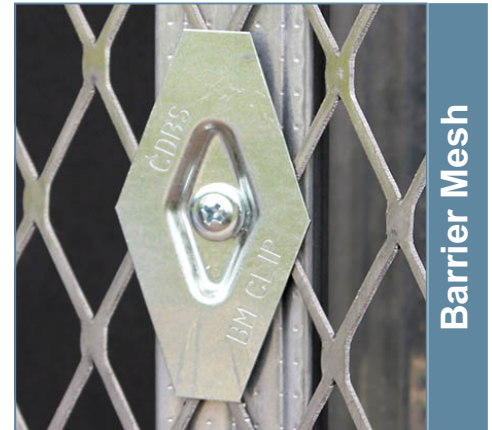

### Installation Recommendations:

Place the appropriate fastener (not included with clips) through the hole in the center of the BM-Clip.

#### Attaching to Steel Studs:

Flat head bugle, self-tapping fine thread Type S screws that penetrate the steel studs a minimum 3/8-inches.

#### Attaching to Wood Framing:

Fine thread Type W wood screws, 1 5/8- inch in length that penetrate the wood studs a minimum 1 1/4-inches.

#### BM-Clip Spacing:

Shall be approximately 12-inches on center over the mesh and into the studs or ceiling joists.

At 16-inch center stud spacing:  
Usage will be 24 clips/ 4' x 8' Barrier Mesh Panel,  
75 BM-Clips/100 SF

At 24-inch center stud spacing:  
Usage will be 16 clips/ 4' x 8' Barrier Mesh Panel,  
50 BM-Clips/100 SF

(Spacing may be increased based on clients needs)

#### Joints:

Barrier Mesh can be butt-joined, or staggered on the mesh joint. Overlapping is allowed, with the owner's approval prior to installation, but will cause a bump in the drywall. Any Barrier Mesh panels not joining on framing members can be lapped and wire-tied with (#18 swg) steel tie wire and same spacing found when using the BM-Clips.

#### Ceilings:

Spacing of clips on a ceiling application may change/increase due to the increased load. Ceiling application and attachment must be verified by the engineer of record.

#### Limitations:

BM-Clips are not recommended for use with Barrier Mesh size BM50 (1/2-inch diamond). Use flat-head or truss-head screws with the BM50 size Barrier Mesh panels.