

Flat Tail™ Slide Clip

Curtain Wall/Bypass

Allows for vertical building movement and provides a horizontal standoff.

ClarkDietrich's Flat Tail™ Slide Clip is used to attach exterior curtain wall studs to the building structure and provide for 2-1/4" vertical building movement independent of the cold-formed steel framing. A Flat Tail Slide Clip provides variable standoff and eliminates the need for shims or additional framing components. The clip easily fastens to the floor/ceiling beam and is secured to the stud with ClarkDietrich Proprietary HD Deflection Screws. The clip restricts lateral movement, but enables vertical movement.

INSTALLATION

Connection to the building can be made with screws, powder-actuated fasteners (PAFs), or by welding. Mechanical fasteners shall be located in the pilot holes. (2) Proprietary HD Deflection Screws are required in each slot to attach the clip to the cold-formed steel framing. Screws shall be placed in the slot with 1" center-to-center spacing using guide lines as a reference.

CLIP THICKNESS

Gauge: 12 gauge (97mils)

Design Thickness: 0.1017 inches

Gauge: 10 gauge (118mils)

Design Thickness: 0.1242 inches

MATERIAL SPECIFICATIONS

Coatings: G90

Yield Strength: 50ksi

ASTM: A653/A1003

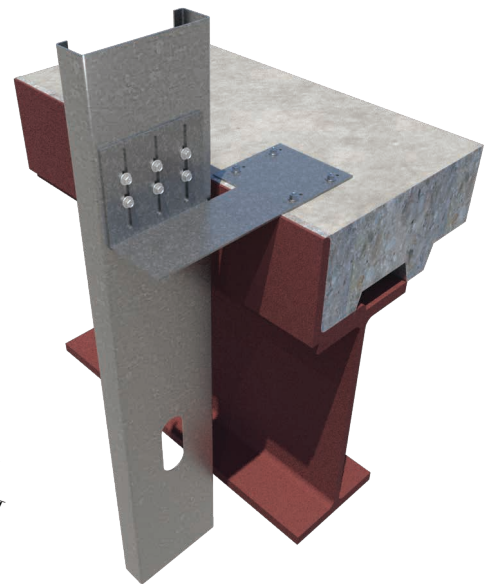
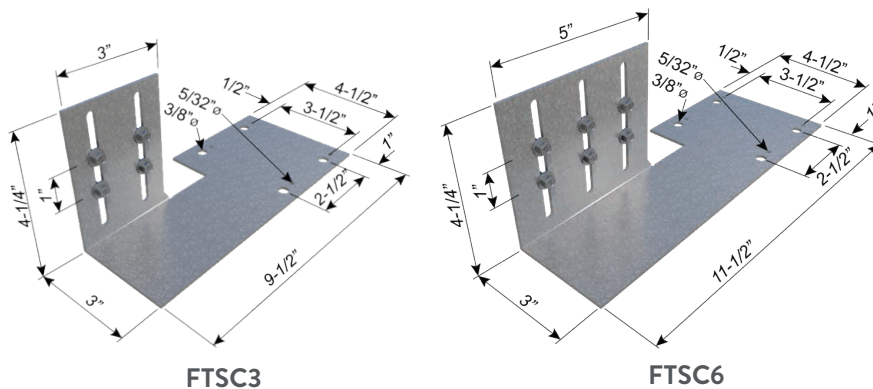

Flat Tail™ Slide Clip (FTSC)

Product code	Product Thickness		Size (in)	Packaging Pcs./Bucket
	Mils (Gauge)	Design thickness (in)		
FTSC3-97	97mils (12ga)	0.1017	4-1/2" x 9-1/2" x 4-1/4"	25
FTSC3-118	118mils (10ga)	0.1242	4-1/2" x 9-1/2" x 4-1/4"	25

Product code	Product Thickness		Size (in)	Packaging Pcs./Bucket
	Mils (Gauge)	Design thickness (in)		
FTSC6-97	97mils (12ga)	0.1017	4-1/2" x 11-1/2" x 4-1/4"	25
FTSC6-118	118mils (10ga)	0.1242	4-1/2" x 11-1/2" x 4-1/4"	25

Notes:

- Clips: 25 clips per bucket.
- Includes 110 Proprietary HD Deflection Screws for FTSC3 per bucket.
- Includes 160 Proprietary HD Deflection Screws for FTSC6 per bucket.

PROPRIETARY DEFLECTION SCREWS

Many of the ClarkDietrich deflection clips include our Proprietary Deflection Screw that has been specifically designed to provide friction-free deflection. These fasteners eliminate drag, binding or resistance that can often occur with common fasteners.

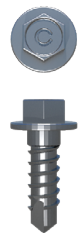

Proprietary HD Deflection Screw (10ga and 12ga Clips Only)

Flat Tail™ Slide Clip

ATTACHMENT TO STRUCTURE: DESIGNED BY OTHERS

3-5/8" Flat Tail™ Slide Clip (FTSC3)

Product code	Stud Thickness / Yield Strength	Attachment to Structure	ASD Allowable Loads (lbs)		
			F1 Load	F2 Load	F3 Load
FTSC3-97	33mils (20ga) 33ksi	(2) Fasteners to be designed by others	110	416	388
	43mils (18ga) 33ksi		144	548	397
	54mils (16ga) 50ksi		261	759	596
	68mils (14ga) 50ksi		268	766	673
	97mils (12ga) 50ksi		468	909	699
	33mils (20ga) 33ksi	(4) Fasteners to be designed by others	110	506	428
	43mils (18ga) 33ksi		144	660	397
	54mils (16ga) 50ksi		261	759	596
	68mils (14ga) 50ksi		268	766	673
FTSC3-118	97mils (12ga) 50ksi	(2) Fasteners to be designed by others	468	909	769
	33mils (20ga) 33ksi		110	607	406
	43mils (18ga) 33ksi		144	816	603
	54mils (16ga) 50ksi		261	816	774
	68mils (14ga) 50ksi		328	924	834
	97mils (12ga) 50ksi	(4) Fasteners to be designed by others	468	924	924
	33mils (20ga) 33ksi		110	607	445
	43mils (18ga) 33ksi		144	816	603
	54mils (16ga) 50ksi		261	816	789
	68mils (14ga) 50ksi		328	924	860
	97mils (12ga) 50ksi		468	924	924

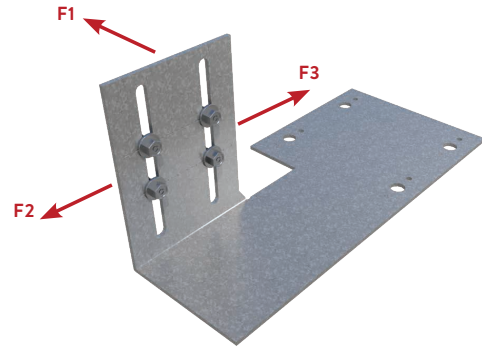

FTSC3

6" Flat Tail™ Slide Clip (FTSC6)

Product code	Stud Thickness / Yield Strength	Attachment to Structure	ASD Allowable Loads (lbs)		
			F1 Load	F2 Load	F3 Load
FTSC6-97	33mils (20ga) 33ksi	(2) Fasteners to be designed by others	165	845	551
	43mils (18ga) 33ksi		216	946	724
	54mils (16ga) 50ksi		316	1057	914
	68mils (14ga) 50ksi		444	1163	962
	97mils (12ga) 50ksi		444	1383	1063
	33mils (20ga) 33ksi	(4) Fasteners to be designed by others	165	869	594
	43mils (18ga) 33ksi		216	959	755
	54mils (16ga) 50ksi		392	1057	930
	68mils (14ga) 50ksi		476	1220	1055
FTSC6-118	97mils (12ga) 50ksi	(2) Fasteners to be designed by others	650	1558	1314
	33mils (20ga) 33ksi		165	861	594
	43mils (18ga) 33ksi		216	1173	874
	54mils (16ga) 50ksi		337	1515	1181
	68mils (14ga) 50ksi		492	1682	1265
	97mils (12ga) 50ksi	(4) Fasteners to be designed by others	492	2026	1439
	33mils (20ga) 33ksi		165	953	594
	43mils (18ga) 33ksi		216	1221	891
	54mils (16ga) 50ksi		392	1515	1215
	68mils (14ga) 50ksi		492	1682	1439
	97mils (12ga) 50ksi		702	2026	1523

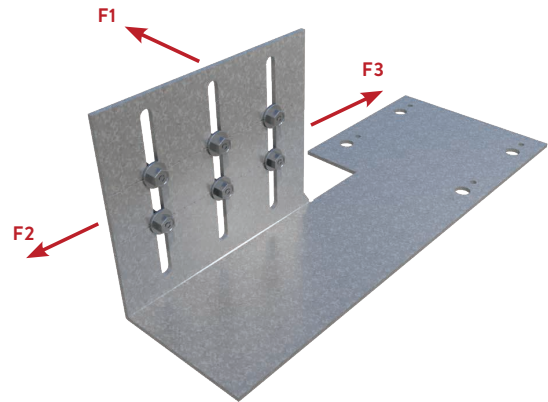

FTSC6

Notes:

- 1 Allowable loads (ASD) listed represent the capacity of the clip to the stud only (framing connection).
- 2 Allowable loads have not been increased for wind, seismic, or other factors.
- 3 (2) #14 Shouldered screws (Proprietary HD Deflection Screws) shall be used per slot, placed with 1-in center-to-center spacing.
 - (4) total screws for the FTSC3 (3-5/8" Clip)
 - (6) total screws for the FTSC6 (6" Clip)
 - #14 Proprietary HD Deflection Screws are provided with each Flat Tail Slide Clip
- 4 It is the responsibility of the design professional to detail the attachment of the clips and verify that their capacity meets the requirements of the intended application.

Flat Tail™ Slide Clip

ATTACHMENT TO STRUCTURE: **WELDED**

3-5/8" Flat Tail™ Slide Clip (FTSC3)

Product code	Stud Thickness / Yield Strength	Attachment to Structure	ASD Allowable Loads (lbs)		
			F1 Load	F2 Load	F3 Load
FTSC3-97	33mils (20ga) 33ksi	(2) Welds - min. 2" length each on either ends	110	506	428
	43mils (18ga) 33ksi		144	660	397
	54mils (16ga) 50ksi		261	759	596
	68mils (14ga) 50ksi		268	766	673
	97mils (12ga) 50ksi		468	909	769
FTSC3-118	33mils (20ga) 33ksi	(2) Welds - min. 2" length each on either ends	110	607	445
	43mils (18ga) 33ksi		144	816	603
	54mils (16ga) 50ksi		261	816	789
	68mils (14ga) 50ksi		328	924	860
	97mils (12ga) 50ksi		468	924	924

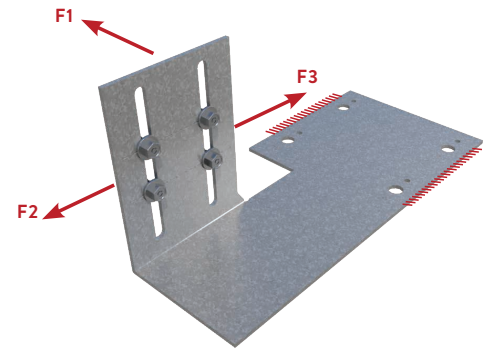

FTSC3

6" Flat Tail™ Slide Clip (FTSC6)

Product code	Stud Thickness / Yield Strength	Attachment to Structure	ASD Allowable Loads (lbs)		
			F1 Load	F2 Load	F3 Load
FTSC6-97	33mils (20ga) 33ksi	(2) Welds - min. 2-3/4" length each on either ends	165	869	594
	43mils (18ga) 33ksi		216	959	755
	54mils (16ga) 50ksi		392	1057	930
	68mils (14ga) 50ksi		476	1220	1055
	97mils (12ga) 50ksi		650	1558	1314
FTSC6-118	33mils (20ga) 33ksi	(2) Welds - min. 2-3/4" length each on either ends	165	953	594
	43mils (18ga) 33ksi		216	1221	891
	54mils (16ga) 50ksi		392	1515	1215
	68mils (14ga) 50ksi		492	1682	1316
	97mils (12ga) 50ksi		702	2026	1523

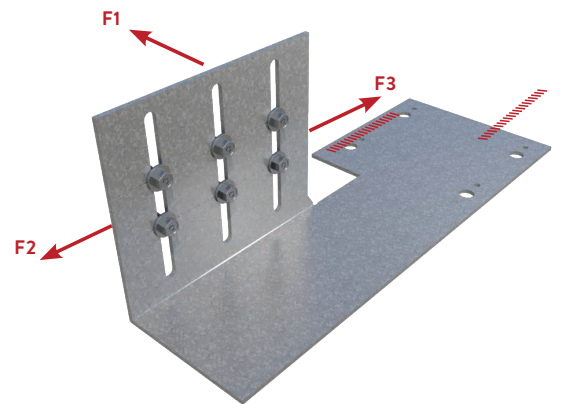

FTSC6

Notes:

- 1 Allowable loads have not been increased for wind, seismic, or other factors.
- 2 (2) #14 Shouldered screws (Proprietary HD Deflection Screws) shall be used per slot - placed with 1-in center-to-center spacing.
 - (4) total screws for the FTSC3 (3-5/8" Clip)
 - (6) total screws for the FTSC6 (6" Clip)
 - #14 Proprietary HD Deflection Screws are provided with each Flat Tail Slide Clip
- 3 The tabulated values for welds are based on the following weld lengths:
 - For FTSC3 (3-5/8" Clip) use (2) 2" of weld along parallel edges of the Flat Tail structural attachment leg. (As shown)
 - For FTSC6 (6" Clip) use (2) 2-3/4" of weld along parallel edges of the Flat Tail structural attachment leg. (As shown)
- 4 Use E70XX (min.) electrodes.
- 5 It is the responsibility of the design professional to detail the attachment of the clips and verify that their capacity meets the requirements of the intended application.

Flat Tail™ Slide Clip

ATTACHMENT TO STRUCTURE: 1/4-28 FASTENERS INTO STEEL

3-5/8" Flat Tail™ Slide Clip (FTSC3)

Product code	Stud Thickness / Yield Strength	Attachment to Structure	ASD Allowable Loads (lbs)		
			F1 Load	F2 Load	F3 Load
FTSC3-97	33mils (20ga) 33ksi	(2) 1/4-28 Fasteners to 3/16" Steel	110	416	388
	43mils (18ga) 33ksi		144	548	397
	54mils (16ga) 50ksi		261	759	596
	68mils (14ga) 50ksi		268	766	673
	97mils (12ga) 50ksi		305	847	699
	33mils (20ga) 33ksi	(4) 1/4-28 Fasteners to 3/16" Steel	110	506	428
	43mils (18ga) 33ksi		144	660	397
	54mils (16ga) 50ksi		261	759	596
	68mils (14ga) 50ksi		268	766	673
FTSC3-118	33mils (20ga) 33ksi	(2) 1/4-28 Fasteners to 3/16" Steel	110	607	406
	43mils (18ga) 33ksi		144	816	603
	54mils (16ga) 50ksi		261	816	774
	68mils (14ga) 50ksi		328	924	834
	97mils (12ga) 50ksi		337	924	924
	33mils (20ga) 33ksi	(4) 1/4-28 Fasteners to 3/16" Steel	110	607	445
	43mils (18ga) 33ksi		144	816	603
	54mils (16ga) 50ksi		261	816	789
	68mils (14ga) 50ksi		328	924	860
97mils (12ga) 50ksi	468	924	924		

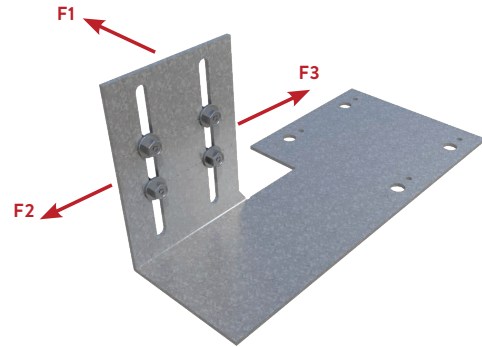

FTSC3

6" Flat Tail™ Slide Clip (FTSC6)

Product code	Stud Thickness / Yield Strength	Attachment to Structure	ASD Allowable Loads (lbs)		
			F1 Load	F2 Load	F3 Load
FTSC6-97	33mils (20ga) 33ksi	(2) 1/4-28 Fasteners to 3/16" Steel	165	845	551
	43mils (18ga) 33ksi		216	847	724
	54mils (16ga) 50ksi		283	847	847
	68mils (14ga) 50ksi		283	847	847
	97mils (12ga) 50ksi		283	847	847
	33mils (20ga) 33ksi	(4) 1/4-28 Fasteners to 3/16" Steel	165	869	594
	43mils (18ga) 33ksi		216	959	755
	54mils (16ga) 50ksi		392	1057	930
	68mils (14ga) 50ksi		476	1220	1055
FTSC6-118	33mils (20ga) 33ksi	(2) 1/4-28 Fasteners to 3/16" Steel	165	861	594
	43mils (18ga) 33ksi		216	931	874
	54mils (16ga) 50ksi		314	931	931
	68mils (14ga) 50ksi		314	931	931
	97mils (12ga) 50ksi		314	931	931
	33mils (20ga) 33ksi	(4) 1/4-28 Fasteners to 3/16" Steel	165	953	594
	43mils (18ga) 33ksi		216	1221	891
	54mils (16ga) 50ksi		392	1375	1215
	68mils (14ga) 50ksi		492	1375	1316
97mils (12ga) 50ksi	702	1375	1375		

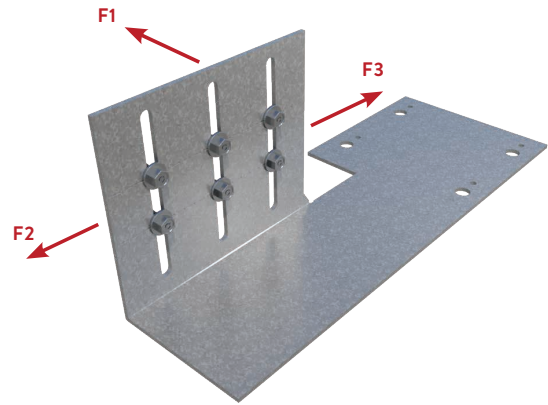

FTSC6

Notes:

- 1 Allowable loads have not been increased for wind, seismic, or other factors.
- 2 (2) #14 Shouldered screws (Proprietary HD Deflection Screws) shall be used per slot - placed with 1-in center-to-center spacing.
 - (4) total screws for the FTSC3 (3-5/8" Clip)
 - (6) total screws for the FTSC6 (6" Clip)
 - #14 Proprietary HD Deflection Screws are provided with each Flat Tail Slide Clip
- 3 1/4-28 Fasteners shall be used for attachment to steel structure. (2) Fastener condition shall be used when a larger offset is required between the structure and the stud. In all other conditions (4) Fastener condition shall be used. Screws to be placed through 5/32" pilot holes in FTSC.
- 4 The minimum edge distance for each fastener type shall comply with the fastener manufacturer's recommendation.
- 5 Capacities listed for 1/4-28 Fasteners are based on screw strengths listed in ICC ESR-1976.
- 6 It is the responsibility of the design professional to detail the attachment of the clips and verify that their capacity meets the requirements of the intended application.

Flat Tail™ Slide Clip

ATTACHMENT TO STRUCTURE: 12-24 FASTENERS INTO STEEL

3-5/8" Flat Tail™ Slide Clip (FTSC3)

Product code	Stud Thickness / Yield Strength	Attachment to Structure	ASD Allowable Loads (lbs)		
			F1 Load	F2 Load	F3 Load
FTSC3-97	33mils (20ga) 33ksi	(2) 12-24 Fasteners to 3/16" Steel	110	416	388
	43mils (18ga) 33ksi		144	548	397
	54mils (16ga) 50ksi		258	716	596
	68mils (14ga) 50ksi		258	716	673
	97mils (12ga) 50ksi		258	716	699
	33mils (20ga) 33ksi	(4) 12-24 Fasteners to 3/16" Steel	110	506	428
	43mils (18ga) 33ksi		144	660	397
	54mils (16ga) 50ksi		261	759	596
	68mils (14ga) 50ksi		268	766	673
FTSC3-118	33mils (20ga) 33ksi	(2) 12-24 Fasteners to 3/16" Steel	110	607	406
	43mils (18ga) 33ksi		144	763	603
	54mils (16ga) 50ksi		261	763	763
	68mils (14ga) 50ksi		276	763	763
	97mils (12ga) 50ksi		276	763	763
	33mils (20ga) 33ksi	(4) 12-24 Fasteners to 3/16" Steel	110	607	445
	43mils (18ga) 33ksi		144	816	603
	54mils (16ga) 50ksi		261	816	789
	68mils (14ga) 50ksi		328	924	860
97mils (12ga) 50ksi	468	924	924		

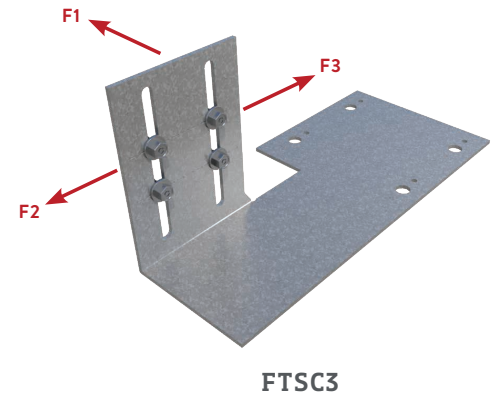

6" Flat Tail™ Slide Clip (FTSC6)

Product code	Stud Thickness / Yield Strength	Attachment to Structure	ASD Allowable Loads (lbs)		
			F1 Load	F2 Load	F3 Load
FTSC6-97	33mils (20ga) 33ksi	(2) 12-24 Fasteners to 3/16" Steel	165	716	551
	43mils (18ga) 33ksi		216	716	716
	54mils (16ga) 50ksi		239	716	716
	68mils (14ga) 50ksi		239	716	716
	97mils (12ga) 50ksi		239	716	716
	33mils (20ga) 33ksi	(4) 12-24 Fasteners to 3/16" Steel	165	869	594
	43mils (18ga) 33ksi		216	959	755
	54mils (16ga) 50ksi		392	1057	930
	68mils (14ga) 50ksi		476	1096	1055
97mils (12ga) 50ksi	541	1096	1096		
FTSC6-118	33mils (20ga) 33ksi	(2) 12-24 Fasteners to 3/16" Steel	165	763	594
	43mils (18ga) 33ksi		216	763	763
	54mils (16ga) 50ksi		256	763	763
	68mils (14ga) 50ksi		256	763	763
	97mils (12ga) 50ksi		256	763	763
	33mils (20ga) 33ksi	(4) 12-24 Fasteners to 3/16" Steel	165	953	594
	43mils (18ga) 33ksi		216	1145	891
	54mils (16ga) 50ksi		392	1145	1145
	68mils (14ga) 50ksi		492	1145	1145
97mils (12ga) 50ksi	576	1145	1145		

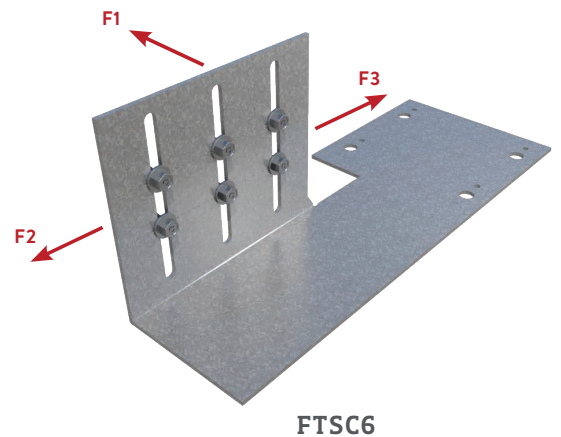

Notes:

- Allowable loads have not been increased for wind, seismic, or other factors.
- (2) #14 Shouldered screws (Proprietary HD Deflection Screws) shall be used per slot - placed with 1-in center-to-center spacing.
 - (4) total screws for the FTSC3 (3-5/8" Clip)
 - (6) total screws for the FTSC6 (6" Clip)
 - #14 Proprietary HD Deflection Screws are provided with each Flat Tail Slide Clip
- #12-24 Fasteners shall be used for attachment to steel structure. (2) Fastener condition shall be used when a larger offset is required between the structure and the stud. In all other conditions (4) Fastener condition shall be used. Screws to be placed through 3/32" pilot holes in FTSC.
- The minimum edge distance for each fastener type shall comply with the fastener manufacturer's recommendation.
- Capacities listed for 12-24 Fasteners are based on screw strengths listed in ICC ESR-1976.
- It is the responsibility of the design professional to detail the attachment of the clips and verify that their capacity meets the requirements of the intended application.

Flat Tail™ Slide Clip

ATTACHMENT TO STRUCTURE: PAF's INTO STEEL

3-5/8" Flat Tail™ Slide Clip (FTSC3)

Product code	Stud Thickness / Yield Strength	Attachment to Structure	ASD Allowable Loads (lbs)		
			F1 Load	F2 Load	F3 Load
FTSC3-97	33mils (20ga) 33ksi	(2) 0.157" PAFs in 3/16" Steel	110	416	388
	43mils (18ga) 33ksi		144	548	397
	54mils (16ga) 50ksi		230	641	596
	68mils (14ga) 50ksi		230	641	641
	97mils (12ga) 50ksi		230	641	641
	33mils (20ga) 33ksi	(4) 0.157" PAFs in 3/16" Steel	110	506	428
	43mils (18ga) 33ksi		144	660	397
	54mils (16ga) 50ksi		261	759	596
	68mils (14ga) 50ksi		268	766	673
FTSC3-118	97mils (12ga) 50ksi	(2) 0.157" PAFs in 3/16" Steel	468	909	769
	33mils (20ga) 33ksi		110	607	406
	43mils (18ga) 33ksi		144	641	603
	54mils (16ga) 50ksi		230	641	641
	68mils (14ga) 50ksi		230	641	641
	97mils (12ga) 50ksi	(4) 0.157" PAFs in 3/16" Steel	230	641	641
	33mils (20ga) 33ksi		110	607	445
	43mils (18ga) 33ksi		144	816	603
	54mils (16ga) 50ksi		261	816	789
	68mils (14ga) 50ksi		328	924	860
97mils (12ga) 50ksi		468	924	924	

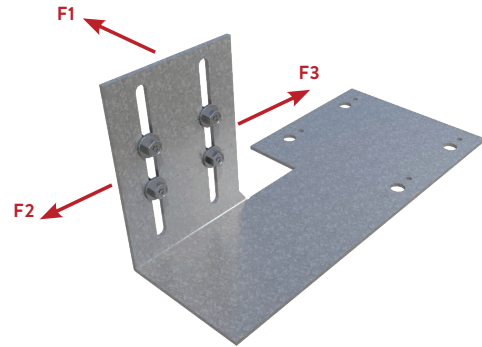

FTSC3

6" Flat Tail™ Slide Clip (FTSC6)

Product code	Stud Thickness / Yield Strength	Attachment to Structure	ASD Allowable Loads (lbs)		
			F1 Load	F2 Load	F3 Load
FTSC6-97	33mils (20ga) 33ksi	(2) 0.157" PAFs in 3/16" Steel	165	641	551
	43mils (18ga) 33ksi		211	641	641
	54mils (16ga) 50ksi		211	641	641
	68mils (14ga) 50ksi		211	641	641
	97mils (12ga) 50ksi		211	641	641
	33mils (20ga) 33ksi	(4) 0.157" PAFs in 3/16" Steel	165	869	594
	43mils (18ga) 33ksi		216	959	755
	54mils (16ga) 50ksi		392	1025	930
	68mils (14ga) 50ksi		476	1025	1025
FTSC6-118	97mils (12ga) 50ksi	(2) 0.157" PAFs in 3/16" Steel	484	1025	1025
	33mils (20ga) 33ksi		165	641	594
	43mils (18ga) 33ksi		211	641	641
	54mils (16ga) 50ksi		211	641	641
	68mils (14ga) 50ksi		211	641	641
	97mils (12ga) 50ksi	(4) 0.157" PAFs in 3/16" Steel	211	641	641
	33mils (20ga) 33ksi		165	953	594
	43mils (18ga) 33ksi		216	1025	891
	54mils (16ga) 50ksi		392	1025	1025
	68mils (14ga) 50ksi		484	1025	1025
97mils (12ga) 50ksi		484	1025	1025	

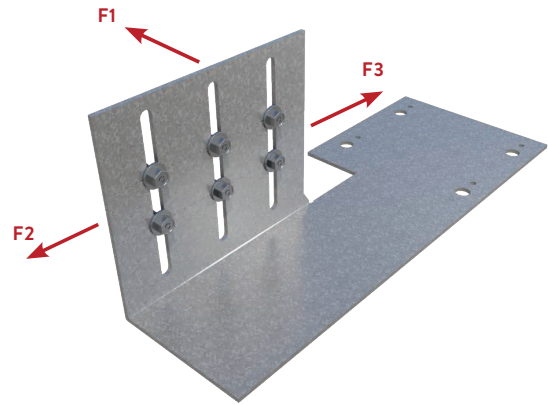

FTSC6

Notes:

- Allowable loads have not been increased for wind, seismic, or other factors.
- (2) #14 Shouldered screws (Proprietary HD Deflection Screws) shall be used per slot - placed with 1-in center-to-center spacing.
 - (4) total screws for the FTSC3 (3-5/8" Clip)
 - (6) total screws for the FTSC6 (6" Clip)
 - #14 Proprietary HD Deflection Screws are provided with each Flat Tail Slide Clip
- 0.157" Hilti XU PAF's shall be used for attachment to steel structure. (2) Fastener condition shall be used when a larger offset is required between the structure and the stud. In all other conditions (4) Fastener condition shall be used. PAF's should be located at cross intersections scribed on the FTSC clip.
- The minimum edge distance for each fastener type shall comply with the fastener manufacturer's recommendation.
- Capacities listed for Hilti PAFs are based on fastener strengths listed in ICC ESR-2269.
- It is the responsibility of the design professional to detail the attachment of the clips and verify that their capacity meets the requirements of the intended application.

Flat Tail™ Slide Clip

ATTACHMENT TO STRUCTURE HILTI KWIK IN CONCRETE

3-5/8" Flat Tail™ Slide Clip (FTSC3)

Product code	Stud Thickness / Yield Strength	Attachment to Structure	ASD Allowable Loads (lbs)		
			F1 Load	F2 Load	F3 Load
FTSC3-97	33mils (20ga) 33ksi	(2) 1/4" Hilti KWIK HUS-EZ (2-1/2" Embedment into 3000 psi uncracked concrete)	110	416	388
	43mils (18ga) 33ksi		144	548	397
	54mils (16ga) 50ksi		261	759	596
	68mils (14ga) 50ksi		268	766	673
	97mils (12ga) 50ksi		303	847	699
FTSC3-118	33mils (20ga) 33ksi	(2) 1/4" Hilti KWIK HUS-EZ (2-1/2" Embedment into 3000 psi uncracked concrete)	110	607	406
	43mils (18ga) 33ksi		144	816	603
	54mils (16ga) 50ksi		261	816	774
	68mils (14ga) 50ksi		303	847	834
	97mils (12ga) 50ksi		303	847	847

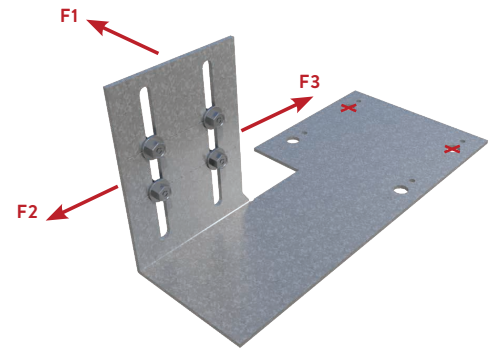

FTSC3

6" Flat Tail™ Slide Clip (FTSC6)

Product code	Stud Thickness / Yield Strength	Attachment to Structure	ASD Allowable Loads (lbs)		
			F1 Load	F2 Load	F3 Load
FTSC6-97	33mils (20ga) 33ksi	(2) 1/4" Hilti KWIK HUS-EZ (2-1/2" Embedment into 3000 psi uncracked concrete)	165	845	551
	43mils (18ga) 33ksi		216	847	724
	54mils (16ga) 50ksi		277	847	847
	68mils (14ga) 50ksi		277	847	847
	97mils (12ga) 50ksi		277	847	847
FTSC6-118	33mils (20ga) 33ksi	(2) 1/4" Hilti KWIK HUS-EZ (2-1/2" Embedment into 3000 psi uncracked concrete)	165	847	594
	43mils (18ga) 33ksi		216	847	847
	54mils (16ga) 50ksi		277	847	847
	68mils (14ga) 50ksi		277	847	847
	97mils (12ga) 50ksi		277	847	847

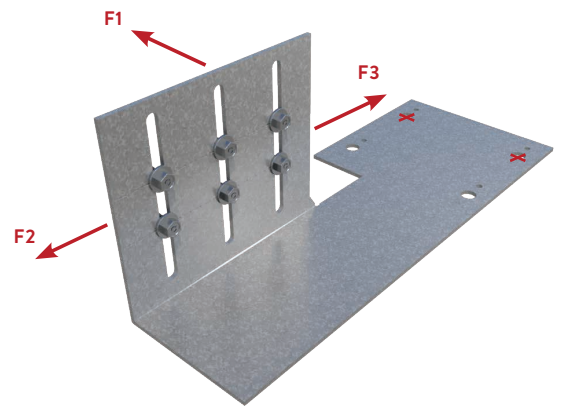

FTSC6

Notes:

- 1 Allowable loads have not been increased for wind, seismic, or other factors.
- 2 (2) #14 Shouldered screws (Proprietary HD Deflection Screws) shall be used per slot - placed with 1-in center-to-center spacing.
 - (4) total screws for the FTSC3 (3-5/8" Clip)
 - (6) total screws for the FTSC6 (6" Clip)
 - #14 Proprietary HD Deflection Screws are provided with each Flat Tail Slide Clip
- 3 1/4" Hilti KWIK HUS-EZ Anchors shall be used for attachment to concrete structure. Anchors shall only be placed in 3/8" diameter holes.
- 4 Capacities listed in the table/notes consider a 3" minimum edge distance for 1/4" Hilti KWIK HUS-EZ anchors embedded 2-1/2" deep into 3000 psi uncracked concrete.
- 5 The load adjustment for 3-1/2" spacing between concrete anchors has been accounted in the tabulated values.
- 6 The minimum concrete thickness (7" thick for 2-1/2" embedment) shall comply with the fastener manufacturer's recommendation.
- 7 It is the responsibility of the design professional to detail the attachment of the clips and verify that their capacity meets the requirements of the intended application.

Flat Tail™ Slide Clip

3-5/8" Flat Tail™ Slide Clip (FTSC3)

Product code	Stud Thickness / Yield Strength	Mechanically Anchored to Structure	ASD Allowable Loads (lbs)					
			Concentric			Eccentric		
			F1 Load	F2 Load	F3 Load	F1 Load	F2 Load	F3 Load
FTSC3-97	97mils (12ga) 50ksi	(2) Fasteners to be designed by others	468	909	699	468	918	647
FTSC3-118	118mils (10ga) 50ksi		468	924	924	468	866	822

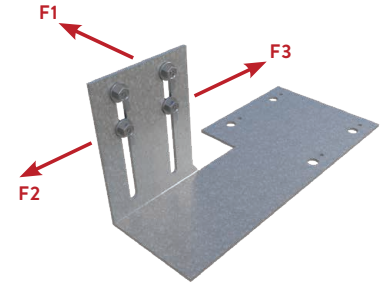

FTSC3

3-5/8" Flat Tail™ Slide Clip (FTSC3)

Product code	Stud Thickness / Yield Strength	Mechanically Anchored to Structure	ASD Allowable Loads (lbs)					
			Concentric			Eccentric		
			F1 Load	F2 Load	F3 Load	F1 Load	F2 Load	F3 Load
FTSC3-97	97mils (12ga) 50ksi	(2) 1/4-28 Fasteners in 3/16" steel	305	847	699	251	689	647
FTSC3-118	118mils (10ga) 50ksi		337	924	924	272	744	744

3-5/8" Flat Tail™ Slide Clip (FTSC3)

Product code	Stud Thickness / Yield Strength	Mechanically Anchored to Structure	ASD Allowable Loads (lbs)					
			Concentric			Eccentric		
			F1 Load	F2 Load	F3 Load	F1 Load	F2 Load	F3 Load
FTSC3-97	97mils (12ga) 50ksi	(2) 12-24 Fasteners in 3/16" steel	258	716	699	213	585	585
FTSC3-118	118mils (10ga) 50ksi		276	763	763	225	616	616

3-5/8" Flat Tail™ Slide Clip (FTSC3)

Product code	Stud Thickness / Yield Strength	Mechanically Anchored to Structure	ASD Allowable Loads (lbs)					
			Concentric			Eccentric		
			F1 Load	F2 Load	F3 Load	F1 Load	F2 Load	F3 Load
FTSC3-97	97mils (12ga) 50ksi	(2) 0.157" PAFs in 3/16" steel	230	641	641	195	538	538
FTSC3-118	118mils (10ga) 50ksi		230	641	641	195	538	538

3-5/8" Flat Tail™ Slide Clip (FTSC3)

Product code	Stud Thickness / Yield Strength	Mechanically Anchored to Structure	ASD Allowable Loads (lbs)					
			Concentric			Eccentric		
			F1 Load	F2 Load	F3 Load	F1 Load	F2 Load	F3 Load
FTSC3-97	97mils (12ga) 50ksi	(2) 1/4" Hilti Kwik HUS-EZ 2-1/2" Embedment in to 3000psi uncracked	303	847	699	259	717	647
FTSC3-118	118mils (10ga) 50ksi		303	847	847	259	717	717

Notes:

- FTSC3 loads based on (4) Proprietary HD Deflection Screws
- FTSC6 loads based on (6) Proprietary HD Deflection Screws

6" Flat Tail™ Slide Clip (FTSC6)

Product code	Stud Thickness / Yield Strength	Mechanically Anchored to Structure	ASD Allowable Loads (lbs)					
			Concentric			Eccentric		
			F1 Load	F2 Load	F3 Load	F1 Load	F2 Load	F3Load
FTSC6-97	97mils (12ga) 50ksi	(2) Fasteners to be designed by others	444	1383	1063	407	1474	1051
FTSC6-118	118mils (10ga) 50ksi		492	2026	1439	622	1962	1629

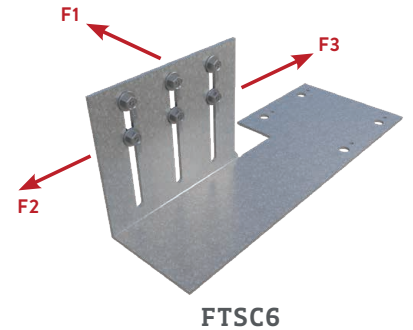

6" Flat Tail™ Slide Clip (FTSC6)

Product code	Stud Thickness / Yield Strength	Mechanically Anchored to Structure	ASD Allowable Loads (lbs)					
			Concentric			Eccentric		
			F1 Load	F2 Load	F3 Load	F1 Load	F2 Load	F3Load
FTSC6-97	97mils (12ga) 50ksi	(2) 1/4-28 Fasteners in 3/16" steel	283	847	847	236	689	689
FTSC6-118	118mils (10ga) 50ksi		314	931	931	257	744	744

6" Flat Tail™ Slide Clip (FTSC6)

Product code	Stud Thickness / Yield Strength	Mechanically Anchored to Structure	ASD Allowable Loads (lbs)					
			Concentric			Eccentric		
			F1 Load	F2 Load	F3 Load	F1 Load	F2 Load	F3Load
FTSC6-97	97mils (12ga) 50ksi	(2) 12-24 Fasteners in 3/16" steel	239	716	716	200	585	585
FTSC6-118	118mils (10ga) 50ksi		256	763	763	212	616	616

6" Flat Tail™ Slide Clip (FTSC6)

Product code	Stud Thickness / Yield Strength	Mechanically Anchored to Structure	ASD Allowable Loads (lbs)					
			Concentric			Eccentric		
			F1 Load	F2 Load	F3 Load	F1 Load	F2 Load	F3Load
FTSC6-97	97mils (12ga) 50ksi	(2) 0.157" PAFs in 3/16" steel	211	641	641	181	538	538
FTSC6-118	118mils (10ga) 50ksi		211	641	641	181	538	538

6" Flat Tail™ Slide Clip (FTSC6)

Product code	Stud Thickness / Yield Strength	Mechanically Anchored to Structure	ASD Allowable Loads (lbs)					
			Concentric			Eccentric		
			F1 Load	F2 Load	F3 Load	F1 Load	F2 Load	F3Load
FTSC6-97	97mils (12ga) 50ksi	(2) 1/4" Hilti Kwik HUS-EZ 2-1/2" Embedment in to 3000psi uncracked	277	847	847	240	717	717
FTSC6-118	118mils (10ga) 50ksi		277	847	847	240	717	717

Notes:

- FTSC3 loads based on (4) Proprietary HD Deflection Screws
- FTSC6 loads based on (6) Proprietary HD Deflection Screws